

PRESSURE LEVEL INDICATOR OPERATION MANUAL

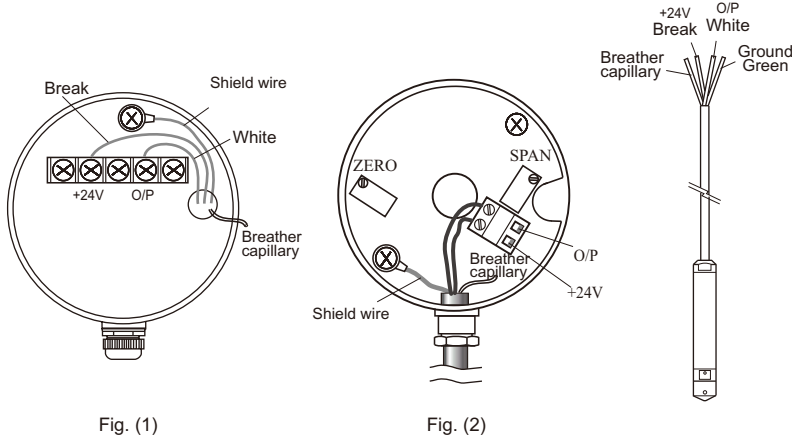

INTERNAL WIRING

- Make sure the power is turned off. Connect them as show in fig.1, 2 or 5 (depend on which model you purchased).
- Make sure the outlet breather capillary is open for air to flow freely.



Wiring of pressure transmitter

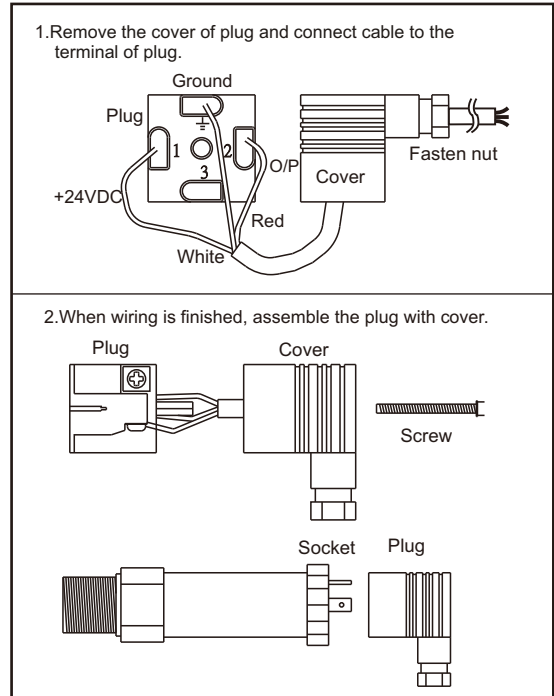

EXTERNAL WIRING

- For FineTek Panel Meter, please refer to the wiring diagram attached. As for other brands of panel meter, please refer to its respective operation manual for their wiring diagram.
- Wiring connection should be kept away from high voltage cable, (e.g. Power cable.) to prevent interference from high voltage.
- Resistance in the circuit should be avoid for wiring connection in order to keep operating voltage higher than 13Vdc.

EC1100~1110
EC1300~1310

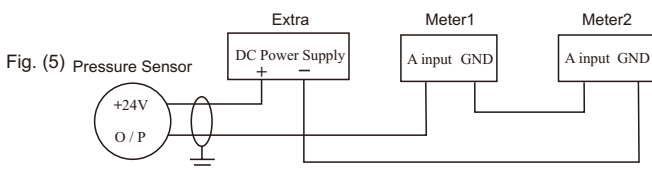
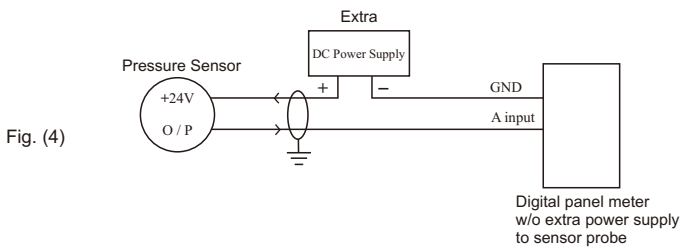
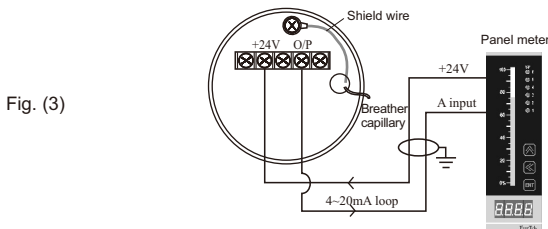

INSTALLATION

1. The transducer with extension cable & types are equipped with an electrical housing standing vertically and with a screw-type of cap on top.
2. The flange type transducer is equipped with a side mounted electrical housing.
3. A special type of cable is used in the transducer with extension cable. Please note that this cable comes with 3 multi-thread copper wire and a breather capillary. Therefore, any bending of the cable is not recommended. Otherwise, the measurements will not be accurate.
4. It is recommended that you use EC1200, when the pressure level measurement of solvent is implemented.
5. The EC can't be used in crystallized or caked liquids.
6. Except for the EC1200, the temperature of measured liquid should be below 80°. When above 80°, please contact sales representative for customized solution.
7. No pressure or vacuum should be present in the tank during measurement.
8. Avoid dropping or bumping the diaphragm during installation.
9. When washing, avoid direct contact & spraying of the diaphragm.
 - Please lock cable tie with full attention. Manual operation is preferred since cable tie is plastic and vulnerable to metal tools.
 - For outdoor application, please install OVP component between power Controller and transmitter.
 - For water+dust proofing, use the diameter 6~10mm, AWG18~22 cord.

